

WARMAN®

Centrifugal Slurry Pumps

SJ Range
Submersible Dewatering Pump

Excellent
Minerals
Solutions



Premium submersible dewatering pump from the global dewatering pump specialists, Weir Minerals.

Ready to use straight from the box

High specification mining cable is supplied as standard.

Can run dry or on snore

Heavy duty construction with double outer casing provides excellent heat convection making it possible to run the pump dry or on snore conditions.

Motor protection

All pumps are fitted with bimetal thermal microswitches in each winding. In sizes up to SJ40, the thermal switches are connected to a built-in contactor that protects the motor from overheating. SJ60 units have an integral control circuit in the motor cable that facilitates external control.

Environmentally safe

Non-toxic coatings and the use of white oil ensure that the pump is environmentally safe.

Long life mechanical seal

Silicone carbide faces on primary seal ensure long seal life in dirty water conditions.

Wear resistant design

A high chrome iron impeller, nitrile covered motor plate and diffuser and a polyurethane wear plate represent the optimum combination of materials technology for dirty water conditions.

Highly flexible

The pump can operate in any position, upright, horizontal or even upside down

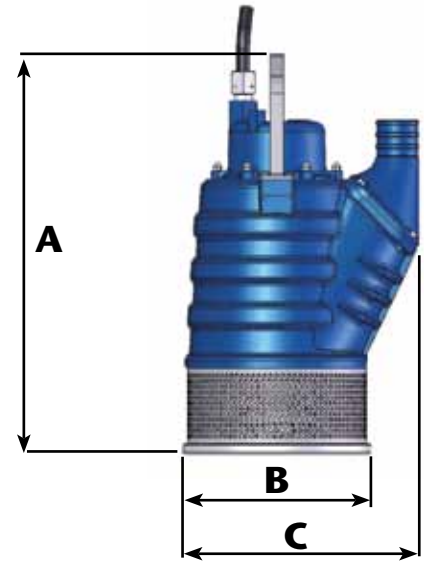
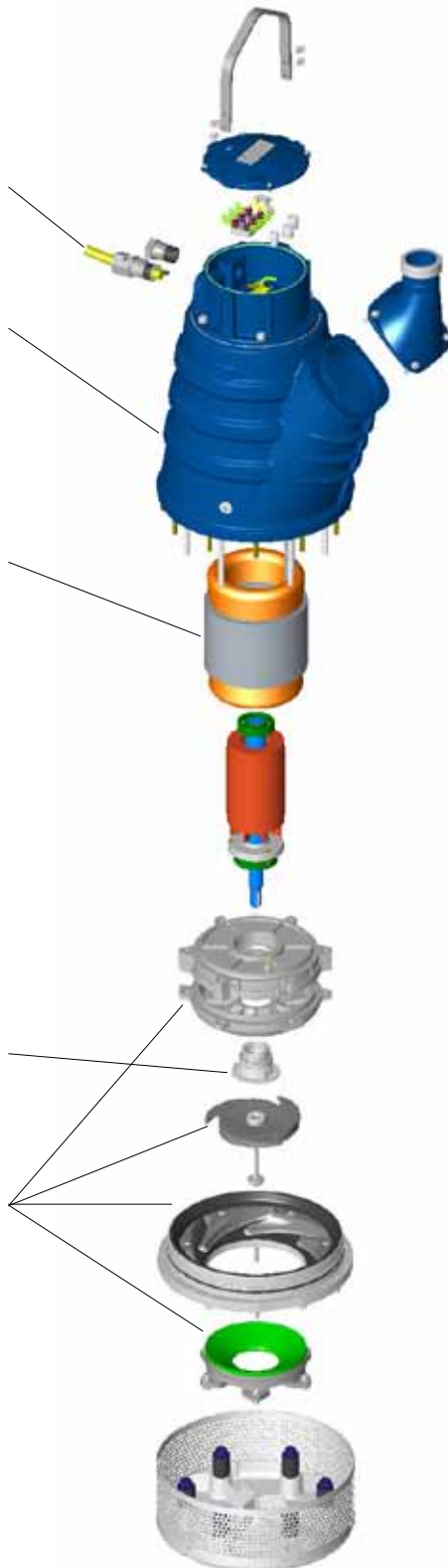

Size	Discharge dia. inches (mm)	Weight lbs. (kg) includes cable	A mm	B mm	C mm
75-140SJ2-2	3 (75)	79 (36)	575	230	308
75-175SJ5-2	3 (75)	130 (59)	686	289	371
75-190SJ8-2	3 (75)	192 (87)	735	289	374
100-160SJ8-2	4 (100)	192 (87)	735	289	374
100-220SJ20-2	4 (100)	396 (180)	960	450	564
150-155SJ20-2	6 (150)	396 (180)	960	450	564
100-250SJ40-2	4 (100)	695 (316)	1114	533	646
150-170SJ40-5	6 (150)	695 (316)	1195	533	646
150-400SJ60-4	6 (150)	1300 (591)	1113	774	892
200-310SJ60-4	8 (200)	1300 (591)	1113	775	907

Product nomenclature explained:

100-220SJ20-2

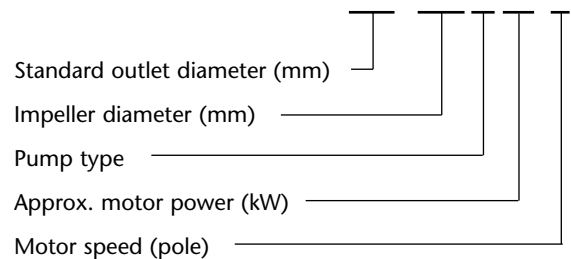

Warman® SJ Submersible Pump Flotation Units

Warman® SJF submersible pump flotation units

The Warman® SJF flotation units are a simple yet highly efficient means of floating the Warman® SJ submersible dewatering pumps.

They have been designed to offer a lightweight, safe and cost effective solution for floating submersible pumps.

Applications

The Warman® SJF flotation units can be used anywhere that requires a Warman® SJ pump to be floating on the surface, such as reclaim or recycle water applications.

Standard features

- Compact and lightweight
- Oil resistant polyethylene filled with expanded polystyrene
- Galvanized steel metal parts
- Central lifting device for easy installation

Benefit to the customer

The Warman® SJF flotation unit provides a simple economical method of keeping the pump off the bottom to avoid plugging or sanding-in of the unit. This in turn allows the inflow of cleaner water into the pump reducing the amount of solids in the pumpage and your system. The result is long product life, minimal maintenance and low ownership cost.



Warman® SJF 20

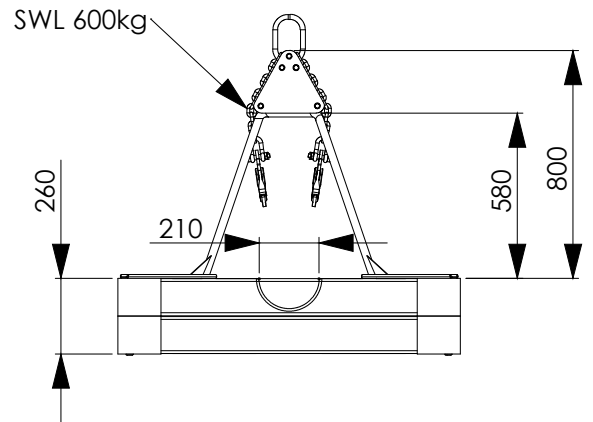

WARMAN® Centrifugal Slurry Pumps

GEHO® PD Slurry Pumps

LINATEX® Rubber Products

VULCO® Wear Resistant Linings

CAVEX® Hydrocyclones

FLOWAY® PUMPS Vertical Turbine Pumps

ISOGATE® Slurry Valves

MULTIFLO® Mine Dewatering Solutions

HAZLETON® Specialty Slurry Pumps

LEWIS® PUMPS Vertical Chemical Pumps

WEIR MINERALS SERVICES™



For further information on any of these products, service or support services contact your nearest sales office or visit:

www.weirminerals.com

Weir Minerals North America - Hazleton

225 N Cedar, Hazleton PA 18201
PO Box 488, Hazleton PA 18201
USA

Tel: +01 570 455 7711
Fax: +01 570 459 2586
www.weirminerals.com



Excellent
Minerals
Solutions

